

# DD721H

## AC Controller Instruction

Version: A/00

### Product Features



DD721H controller

- Wireless receiver
- Light-touch
- Support for jogging mode function
- Input voltage: AC 230V/50Hz
- Rated power: AC motor 500w  
DC LED light 30w
- Working temperature:  $-10^{\circ}\text{C} \sim +50^{\circ}\text{C}$
- One DD721H controller can pair  
Max. 10 channels, once full, the extra  
channel will replace the last paired  
channel repeatedly

### Radio Range

Note: The effective radio distance will deviate due to the actual environment.

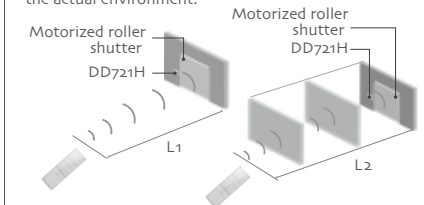

AC 230V/50Hz	L1(outdoor)	L2(indoor)	Radio frequency
	200m	35m	433.92MHz

### Matchable Emitter

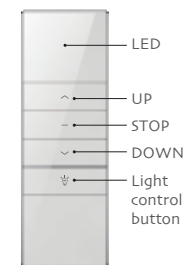
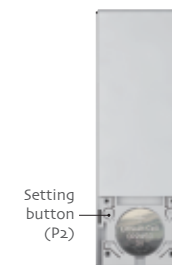
DD1600HE  
Single-channel emitterDD1600HE  
Back

### Matchable Motors And Instruction Of Buttons

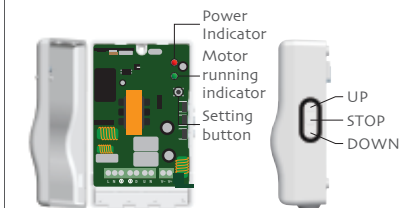
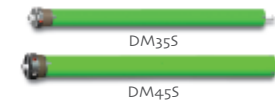

### Wiring

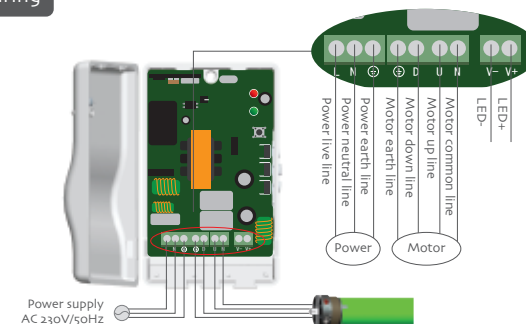

### Best Installation Distance

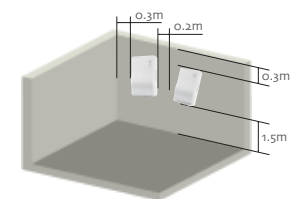

- The shortest distance between controller and ground  $\geq 1.5\text{m}$
- The shortest distance between controller and roof  $\geq 0.3\text{m}$
- The shortest distance between controller and controller  $\geq 0.2\text{m}$

## Pairing

Note: During the setting status, every operation should be less than 10s, or else, it will exit the setting and back to original status.

### Method one

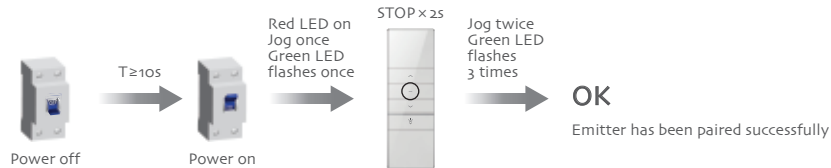

### Method two

Note: Emitter **a** is paired one while emitter **b** is the unpaired one.

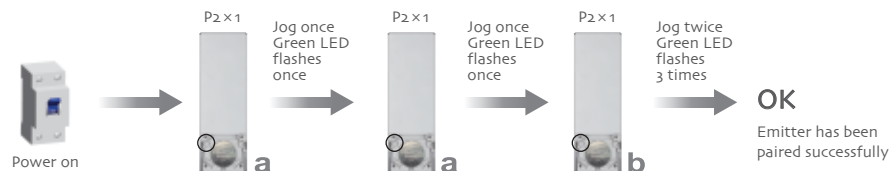

## Switch Direction



## Jog Running Mode And Continuous Running Mode Switch

### Under jog running mode

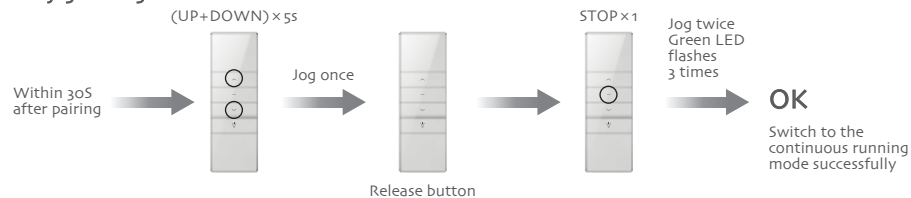

### Under continuous running mode

Note: under jog running mode, press UP or DOWN button once, the motor will be jog running; press more than 25, the motor will be continuous running.

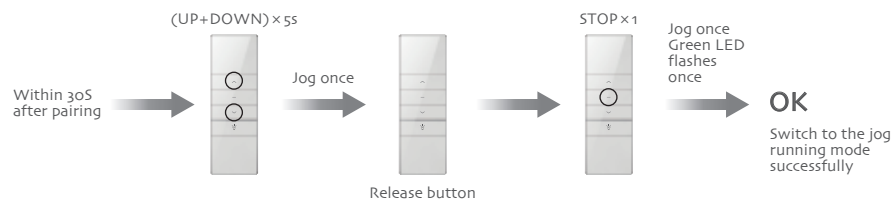

## Delete One Additional Emitter

### Method one

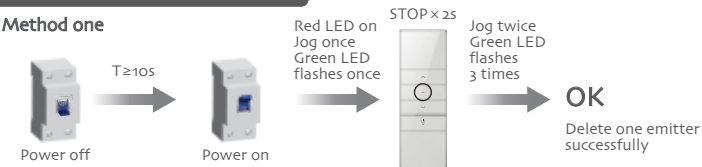

### Method two

(UP+DOWN) × 25

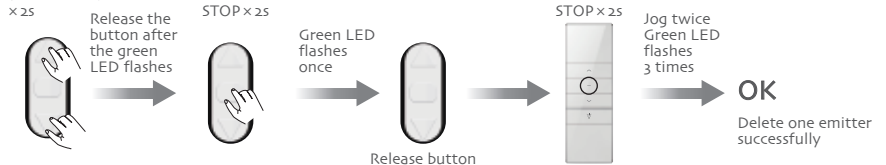

### Method three

Note: Emitter **a** and emitter **b** are paired emitter; and emitter **b** is the one that needs to be deleted.

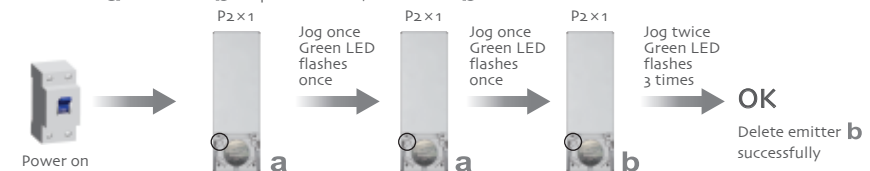

## Delete All Additional Emitters

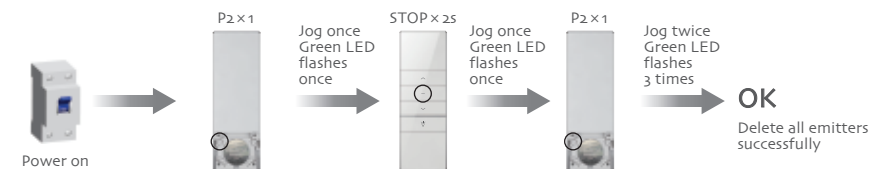

## Controller Setting Button Function

