

SAFETY NOTE

- 1, This appliance can be used by children aged from 8 years and above and persons with reduced physical, sensory or mental capabilities or lack of experience and knowledge if they have been given supervision or instruction concerning use of the appliance in a safe way and understand the hazards involved.
- 2, Children shall not play with the appliance.
- 3, Cleaning and user maintenance shall not be made by children without supervision.
- 4, If the supply cord is damaged, it must be replaced by the manufacturer, its service agent or similarly qualified persons in order to avoid a hazard.
- 5, WARNING: the drive shall be disconnected from its power source during cleaning, maintenance and when replacing parts.
- 6, The instructions shall state that the A-weighted emission sound pressure level of the drive is equal to or less than 70 dB(A), e.g. by writing $LpA \leq 70 \text{ dB(A)}$.
- 7, The mass and the dimension of the driven part shall be compatible with the rated torque and rated operating time.
- 8, The type of driven part the drive is intended for.
- 9, WARNING: Important safety instructions. It is important for the safety of persons to follow these instructions. Save these instructions.
- 10, Do not allow children to play with fixed controls. Keep remote controls away from children
- 11, Frequently examine the installation for imbalance and signs of wear or damage to cables and springs. Do not use if repair or adjustment is necessary
- 12, Watch the moving shutter and keep people away until he shutter is completely closed
- 13, WARNING: Important safety instructions. Follow all instructions, since incorrect installation can lead to severe injury.
- 14, Before installing the drive, remove any unnecessary cords and disable any equipment not needed for powered operation



Tubular Motor-DM45EDM/S

Specification

(A-00)

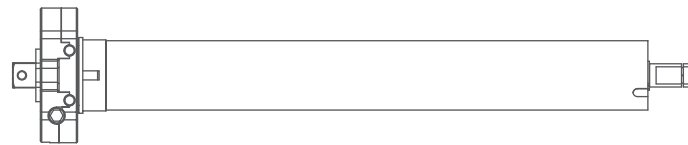

Product introduction

⚠ One motor maximum can store 10 channels, over 10 channels, if still need add new emitters, it will be repeating covered last channel.



Functional features:

- Electronic Limit
- Precise Limit Setting
- Built-in Receiver
- Preferred Stop Position
- Manual Override
- Switch Direction
- Stall Protection
- Jog & Tilt
- Program Button

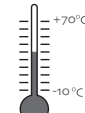

Working Temperature

Parameter (More models and parameters are subject to the nameplate)

Type	Rated Torque (N.m)	Rated Speed (r/min)	Rated Current (A)	Rated Power (W)	Rated Voltage (V)	Emission Frequency (MHz)
DM45EDM/S	20N	15r	0.69A	161W	230V	433.925MHz
	30N	15r	0.87A	200W	230V	433.925MHz
	40N	15r	0.99A	228W	230V	433.925MHz
	50N	12r	0.99A	228W	230V	433.925MHz

Motor installation

- ①Driving tube must be close-fitting with crown and drive adapter.
- ②Choose crown and drive adapter based on the driving tube.

1

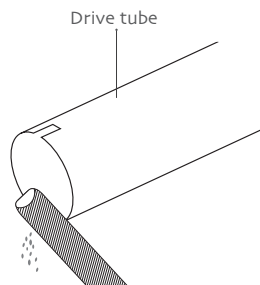
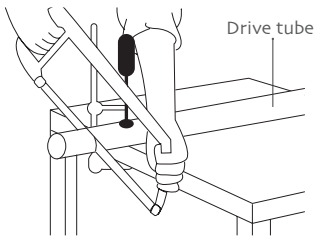

2

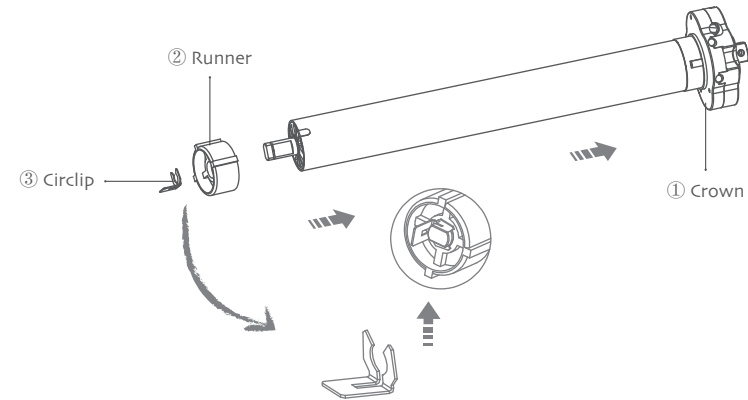

3

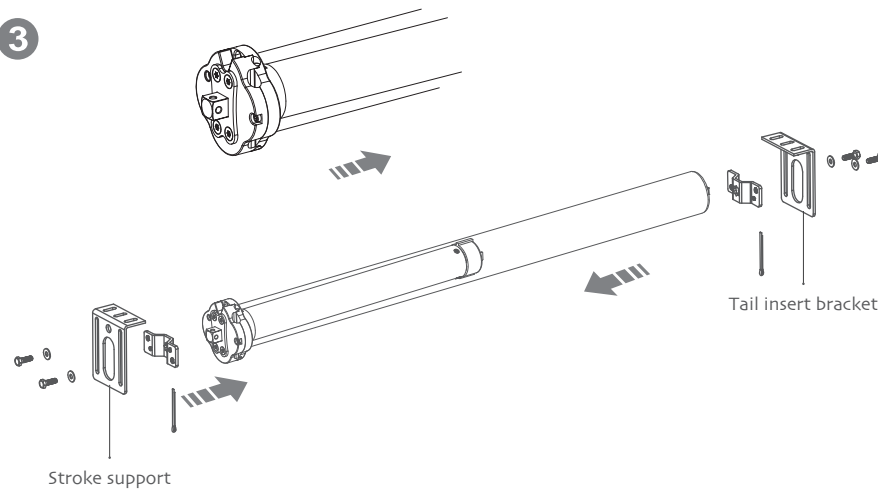

4

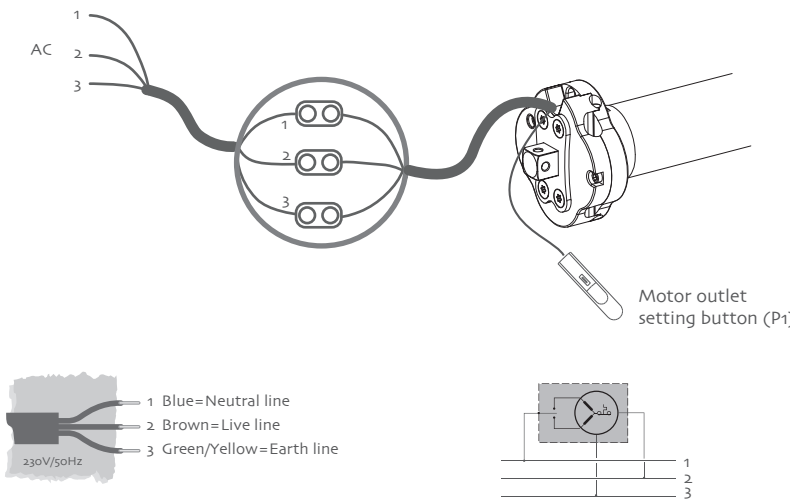

Button specification

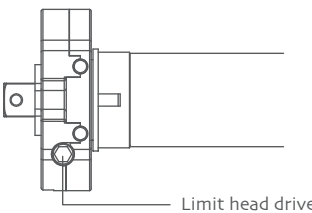
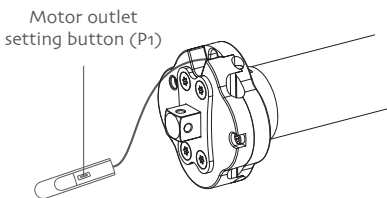

Operation note

⚠ Please read the following precautions before use:

1. Operating:
 - ① The valid interval of the emitter button is 6s,the emitter will quit the set after 6s.
 - ② The motor will run or "Di" for hint, please do the next step after the hint.
2. Set limit position :
 - ① After the up/down limit positin setting,and the up/down limit positin and preferred stop position can't at the same position.
 - ② After limit setting, with power off and memory function.
 - ③ Limit delete will clear all limit memory.
 - ④ It will exit limit setting when program there is no operation for 2 minutes.
 - ⑤ When the motor moving up or down, can be short press the emitter P2 button 1s, the curtain up or down to jog-move the fine-tuning operation.Press the stop button to exit.
3. If the emitter lost, please setting up again with new emitter.
4. The type ED shade canopy motor runs to the closed limit position and then runs to the opened limit positio to run once, and automatically adjusts the limit when it runs to 50 times.
5. The hand function of the motor is to rely on the internal gear of the motor to pick up the signal, and to ensure that the inner gear sleeve follows the motor to rotate the limit, so as to avoid the change of the limit.



1 Setting up

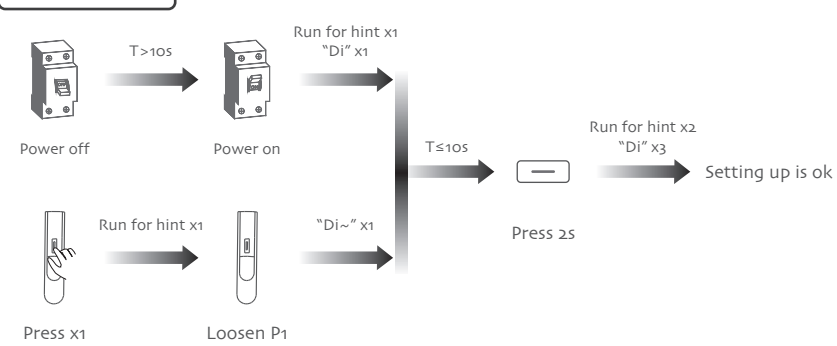

Note: No limit conditions for operation is setting up;In a limit state of operation setting up are added emitter.Not to delete emitter code,limit;If press the up button,the curtains run down,please perform the commutation operation.

2 Switch direction

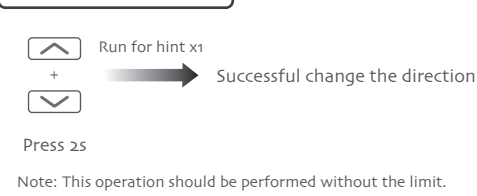

3 Limit position setting

When there is no limit, the motor will jog-move, and the long press up/down button will run continuously for 2s. After the limit, the motor will run continuously.

1, Manually set the closed limit Up→Up+Stop

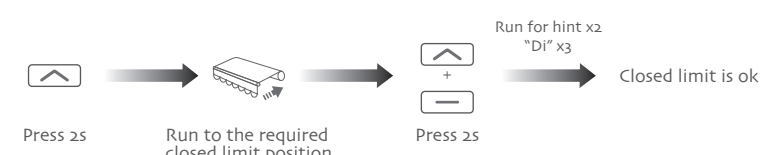

2, Manually set the opened limit Down→Down+Stop

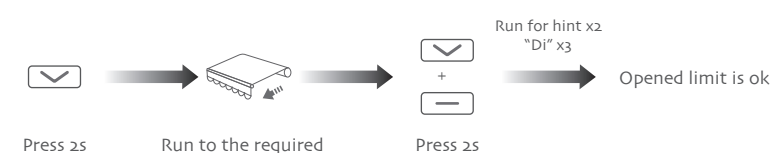

3, Automatically set the closed limit Up

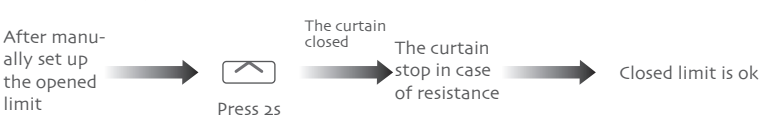

Note: Automatic set the closed limit can only be carried out in ED mode; Type E mode can only use manual setting of closed limit.

4 Preferred stop position

1, Set preferred stop position P2→Stop→Stop

After the opened limit and closed limit setting, you can set preferred stop position between them as the half open position.

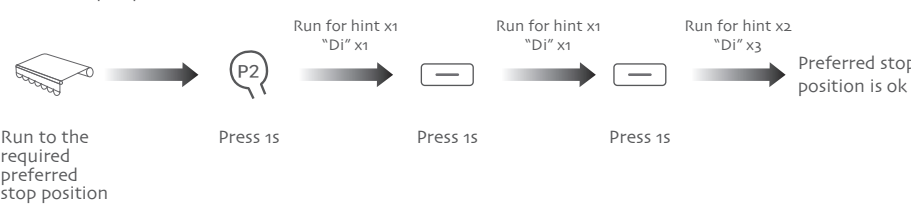

2, Run to preferred stop position Stop

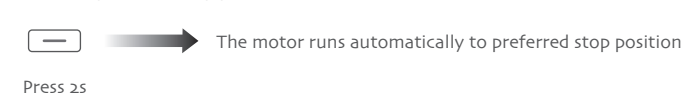

3, Clear preferred stop position P2→Stop→Stop



5 Jog & Tilt

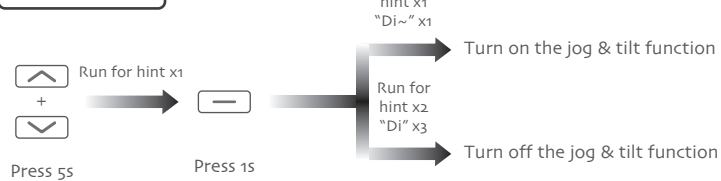

Note: Jog & Tilt function must be set in the opened/closed limit can be set up;Jog & tilt function is turned on, press the up button or down button motor jog, long press for more than 2s, the motor continues to rotate; turn off the jog & tilt function, the motor continuous operation.

6 Type E/Type ED switch



Note: The factory default ED type shade canopy motor.

7 Fine-tuning the limit position

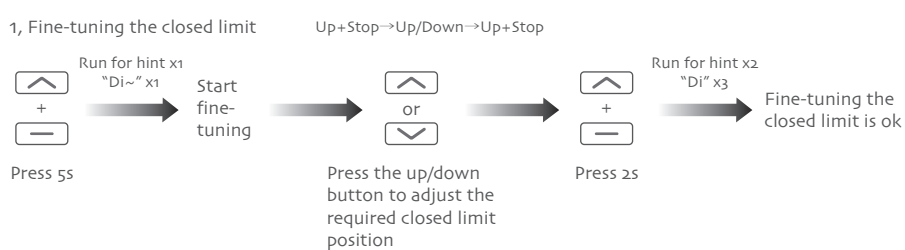

2, Fine-tuning the opened limit Down+Stop→Up/Down→Down+Stop

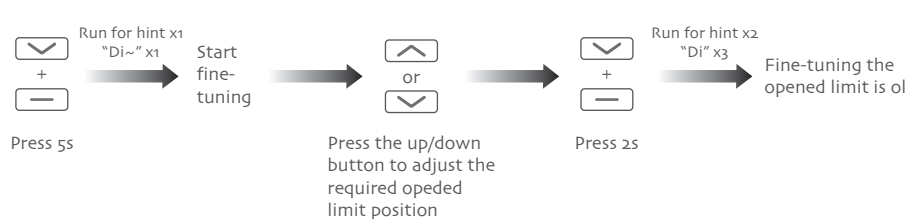

Note: The fine-tuning settings are only valid for ordinary type E motor;Enter the fine-tuning mode for 2 minutes;If not confirm the new limit position,exit fine tuning mode and restore the original limit position.

8 Type ED motor limit position return function

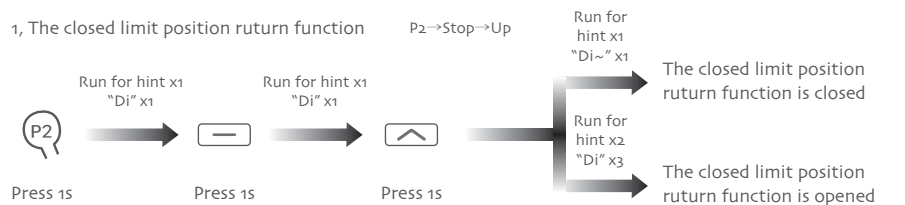

2, The opened limit position return function P2→Stop→Down



Note: The factory default open return function.

9 Add emitter

Method one P2→P2→P2

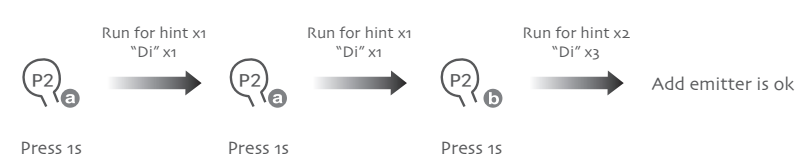

Method two P2→P2→Stop

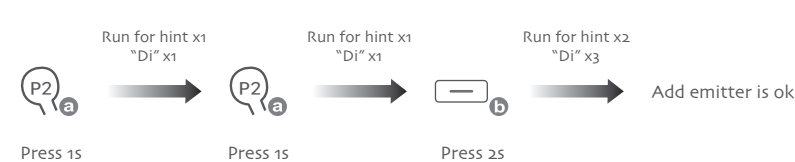

Method three Stop

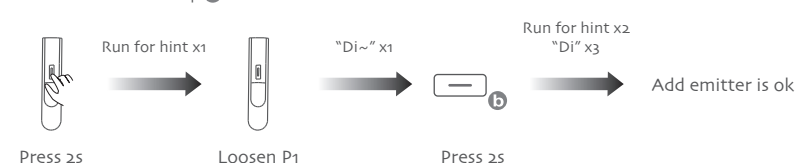

Note: Emitter 1 is the one already matched code,emitter 2 has not.

10 Delete emitter

1, Delete one emitter P2→P2→P2

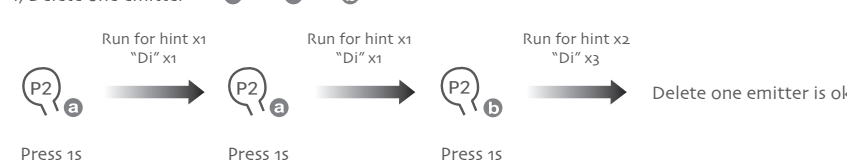

Note: 1, 2 are all of the code emitters,this method only can delete the emitter 2 not the emitter 1

2, Delete all emitters P2→Stop→P2

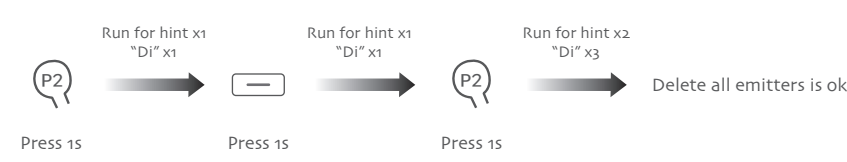

Note: After deleting all the emitters, keep the limit data.

11 Cancel limit

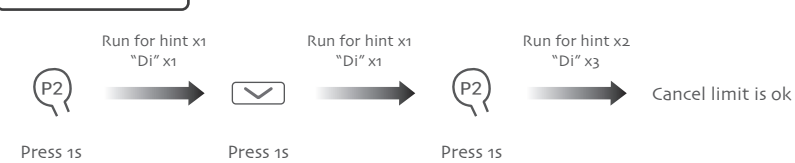

Note: this operation is deleted along with the preferred stop position.

12 The hand-rolling function

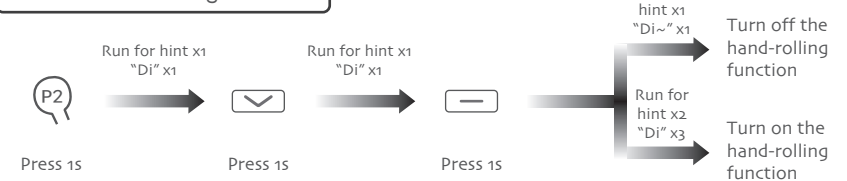

Note: the hand-rolling function is opened by default. In hand-rolling function under the condition of open, stop running motor power or power off, can by hand rod rotation limit make motor rotation, mobile distance is memory, the original limit unchanged; When setting the limit, do not use the hand-rolling function, so as to avoid the limit setting failure; Do not crank the motor when the hand-rolling function is switched off or the motor is running, otherwise the limit will change; When using the hand-rolling function when the limit is set, the hand-rolling motor is forbidden to go beyond the position of the limit, otherwise the limit cannot be resumed.

Motor P1 button operation

1, Cycle running function

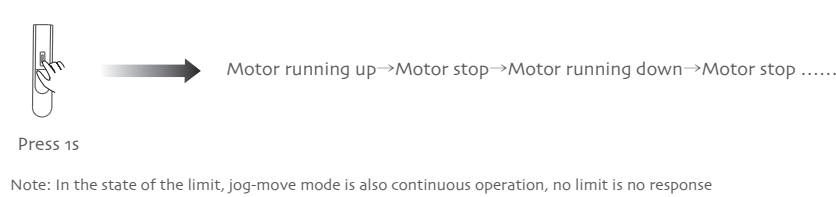

2, Setting up or add emitter

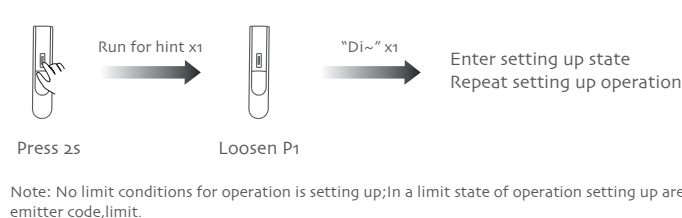

3, Wireless shielding function

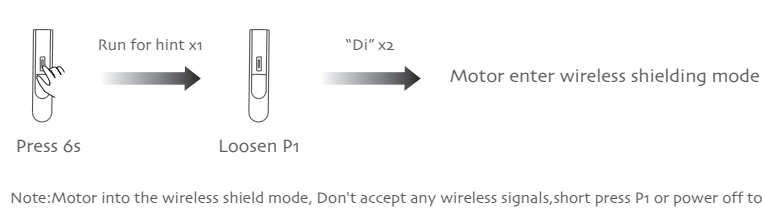

4, Switch direction

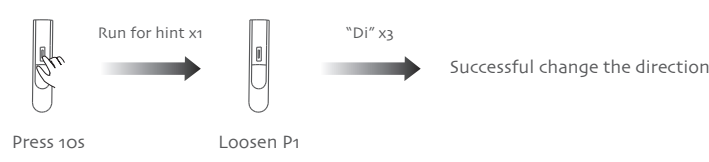

5, Reset to factor mode

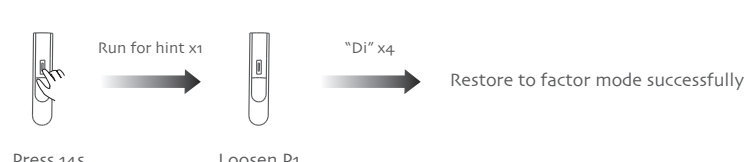

Fault and solution

NUMBER	PHENOMENON	REASON	PROCESSING METHOD
1	Motor can't running	a, The emitter is not mached. b, If long press the P1 button, the motor still don't run, power short-circuit,circuit board bad or motor bad.	a, Setting up again b, Contact after-sales service

Tubular Motor-DM45EDM/S Specification



(A-00)