

SAFETY NOTE

- 1, This appliance can be used by children aged from 8 years and above and persons with reduced physical, sensory or mental capabilities or lack of experience and knowledge if they have been given supervision or instruction concerning use of the appliance in a safe way and understand the hazards involved.
- 2, Children shall not play with the appliance.
- 3, Cleaning and user maintenance shall not be made by children without supervision.
- 4, If the supply cord is damaged, it must be replaced by the manufacturer, its service agent or similarly qualified persons in order to avoid a hazard.
- 5, WARNING: the drive shall be disconnected from its power source during cleaning, maintenance and when replacing parts.
- 6, The instructions shall state that the A-weighted emission sound pressure level of the drive is equal to or less than 70 dB(A), e.g. by writing LpA ≤ 70 dB(A).
- 7, The mass and the dimension of the driven part shall be compatible with the rated torque and rated operating time.
- 8, The type of driven part the drive is intended for.
- 9, WARNING: Important safety instructions. It is important for the safety of persons to follow these instructions. Save these instructions.
- 10, Do not allow children to play with fixed controls. Keep remote controls away from children
- 11, Frequently examine the installation for imbalance and signs of wear or damage to cables and springs. Do not use if repair or adjustment is necessary
- 12, Watch the moving shutter and keep people away until he shutter is completely closed
- 13, WARNING: Important safety instructions. Follow all instructions, since incorrect installation can lead to severe injury.
- 14, Before installing the drive, remove any unnecessary cords and disable any equipment not needed for powered operation



Tubular Motor-DM45EAF/S Specification



(A-00)

Product introduction

One motor maximum can store 10 channels, over 10 channels, if still need add new emitters, it will be repeating covered last channel.

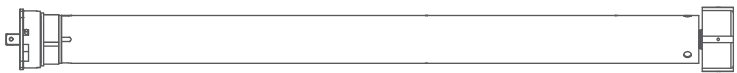

Functional features:

- Electronic Limit
- Precise Limit Setting
- Built-in Receiver
- Preferred Stop Position
- Auto Limit Setting
- Sensitive Stall Detection
- Switch Direction
- Stall Protection
- Jog & Tilt
- Program Button
- Auto Limit Calibration
- Super Reliable Stall Detection

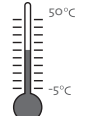

Working Temperature

Parameter (More models and parameters are subject to the nameplate)

Type	Rated Torque (N.m)	Rated Speed (r/min)	Rated Current (A)	Rated Power (W)	Rated Voltage (V)	Emission Frequency(MHz)
DM45EAF/S	10N	15r	0.48A	113W	230V	433MHz
	10N	26r	0.69A	161W	230V	433MHz
	20N	15r	0.69A	161W	230V	433MHz
	20N	26r	0.9A	205W	230V	433MHz
	30N	15r	0.87A	200W	230V	433MHz

Motor installation

- ①Driving tube must be close-fitting with crown and drive adapter.
- ②Choose crown and drive adapter based on the driving tube.

1

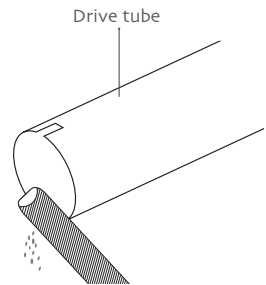
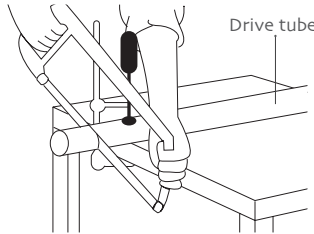

2

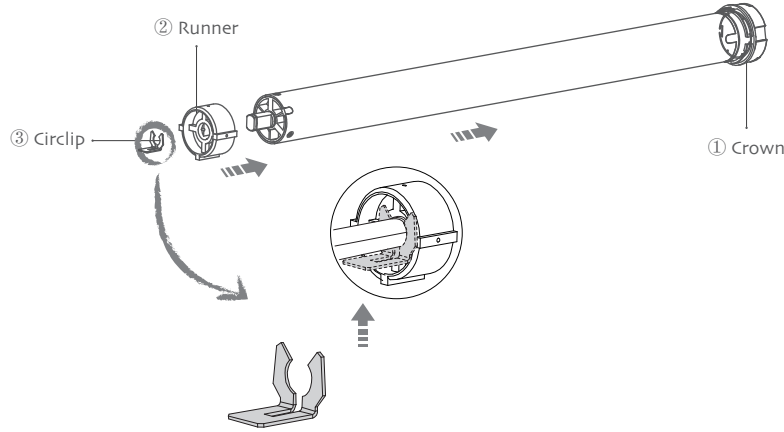

3

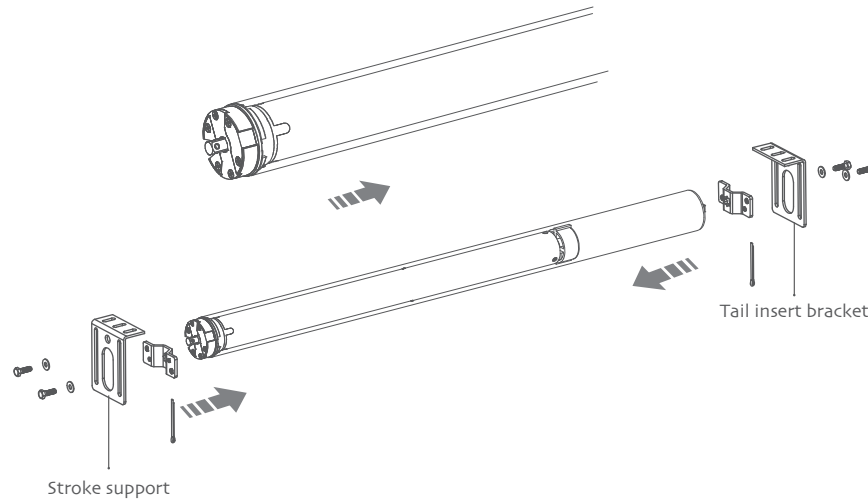

4

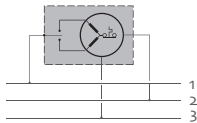
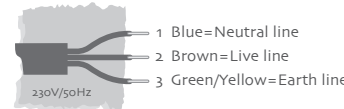
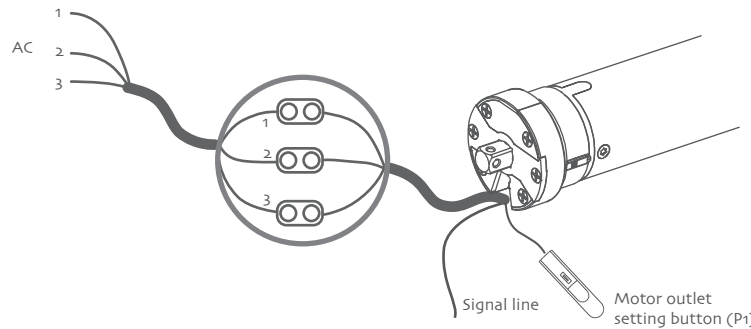

Button specification

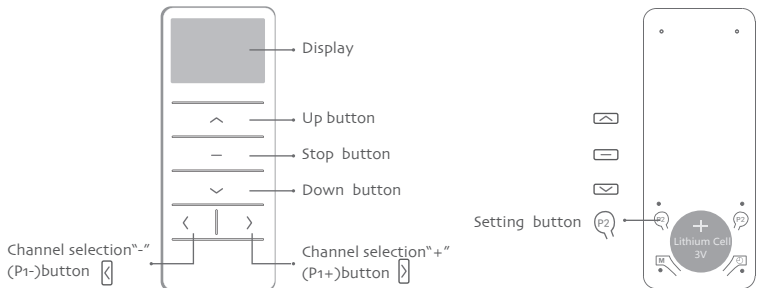
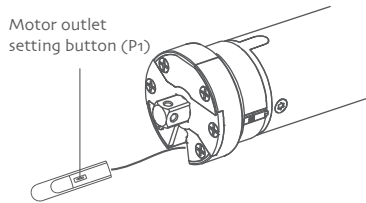

Operation note

Please read the following precautions before use:

1. Operating:
 - ① The valid interval of the emitter button is 6s,the emitter will quit the set after 6s.
 - ② The motor will run or "Di" for hint, please do the next step after the hint.
2. Set limit position:
 - ① After the up/down limit positin setting,and the up/down limit positin and preferred stop position can't at the same position.
 - ② After limit setting, with power off and memory function.
 - ③ Limit delete will clear all limit memory.
 - ④ It will exit limit setting when program there is no operation for 2 minutes.
 - ⑤ When the motor moving up or down, can be short press the emitter P2 button 1s, the curtain up or down to jog-move the fine-tuning operation.Press the stop button to exit.
3. If the emitter lost, please setting up again with new emitter.
4. Mode 1 motor automatic setting the limit function, for self-locking structure of the zib screen, and the weight of the end beam needs to be greater than 5Kg.



1 Setting up

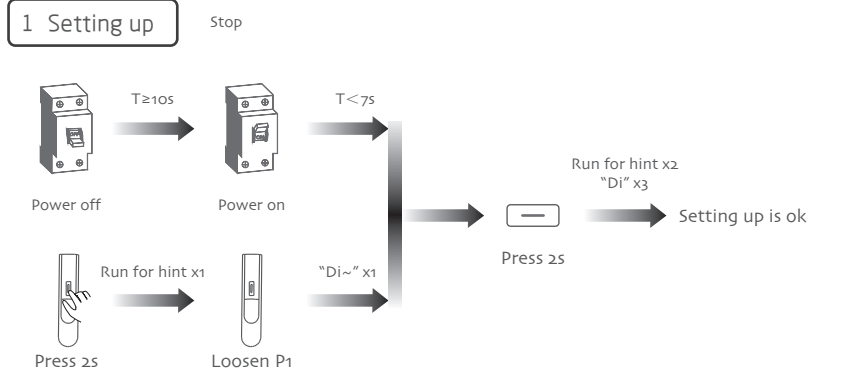

Note: No limit conditions for operation is setting up; In a limit state of operation setting up are added emitter. Not to delete emitter code, limit; If press the up button, the curtains run down, please perform the commutation operation.

2 Switch direction

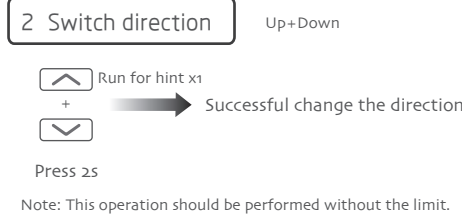

3 Set the up/down limit position

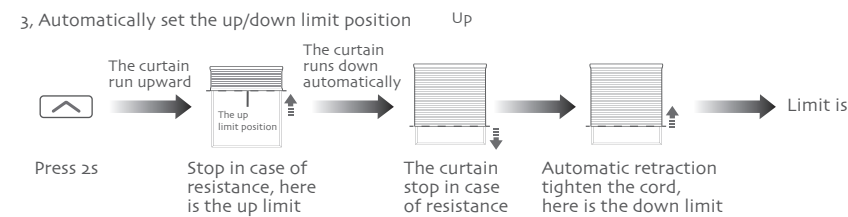
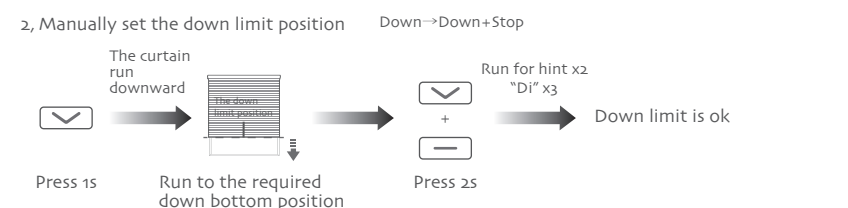
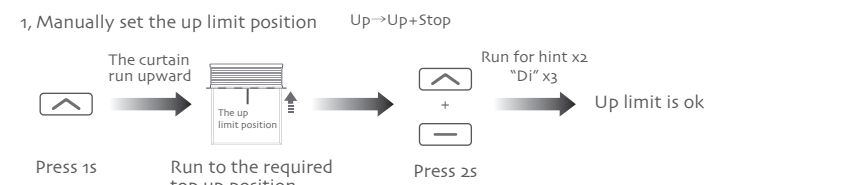

Note: Automatically set the limit function must be mode 1 can be carried out; Automatically set the limit, motor running to the down limit on the run to up limit to run once, run to 50 times under the automatically correct the down limit (reset the down limit automatically), if the fine-tuning or change the original limit to stop counting automatic correction.

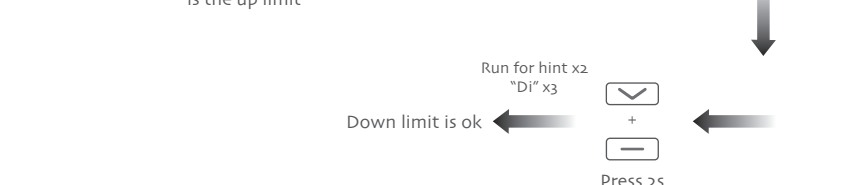
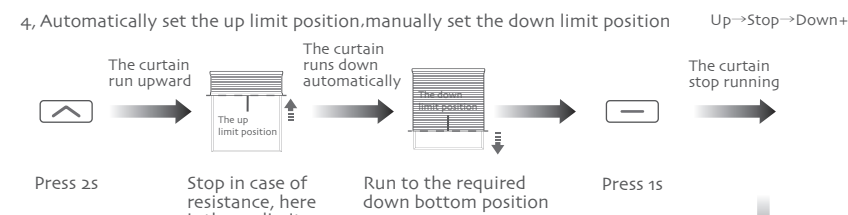

Note: In setting the limit, to set up and down limit (can be set the up limit first, and then set the down limit; can also be set the down limit first, then set the up limit). The motor will jog-move if there is no limit position; it will continuous run if long press 2s up or down button, after setting the limit, the motor runs continuously.

4 Preferred stop position

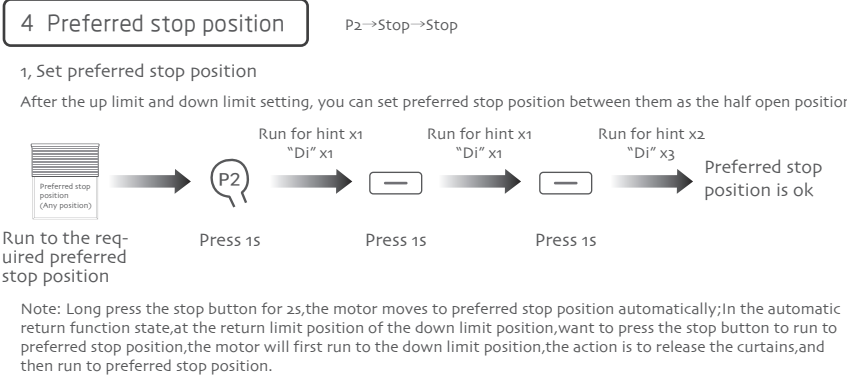

2, Clear preferred stop position

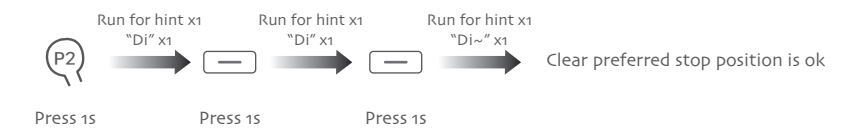

5 Motor mode switching

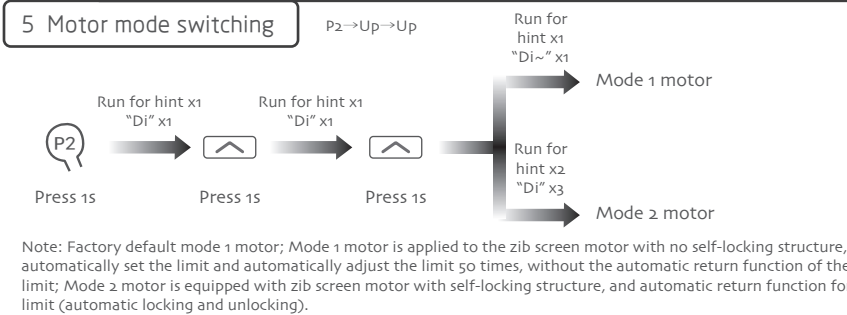

6 Fine-tuning the up/down limit position

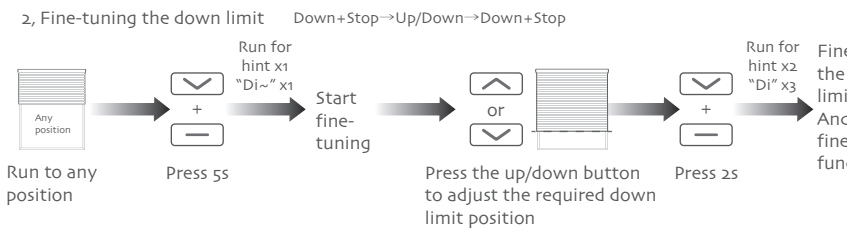
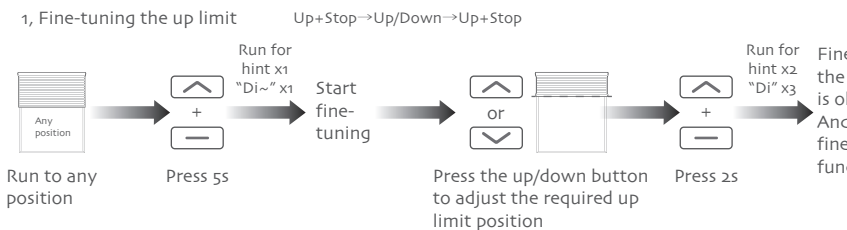

Note: Fine tuning setting is only available to the common E type motor; Enter Trim Mode for 2 minutes, if not confirm the new limit position, exit fine tuning mode and restore the original limit position.

7 EAC motor down limit back function

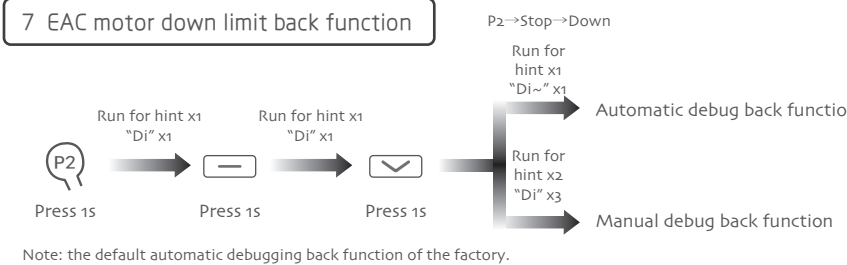

8 Add emitter

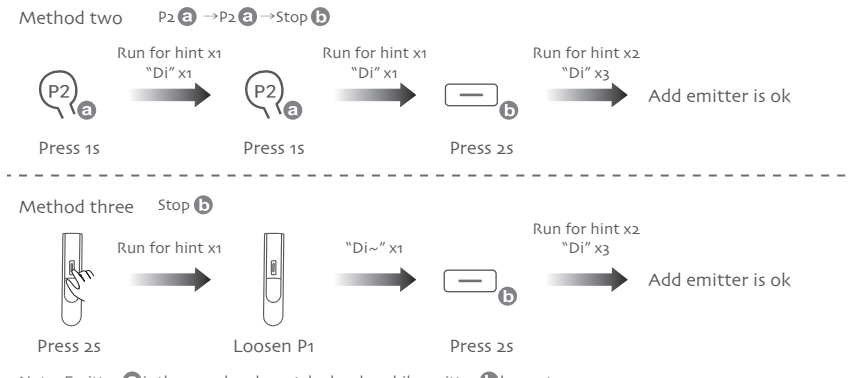
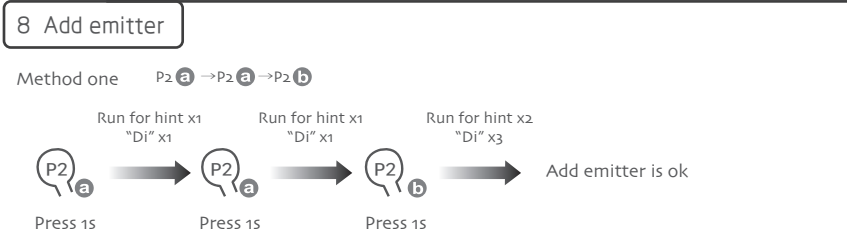

9 Delete emitter

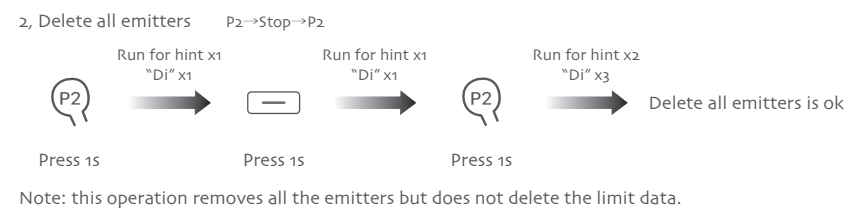
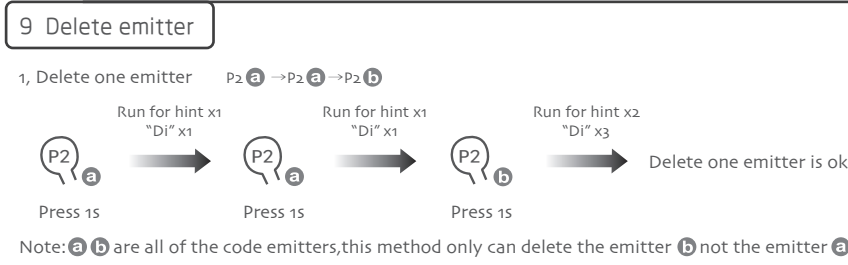

10 Cancel limit

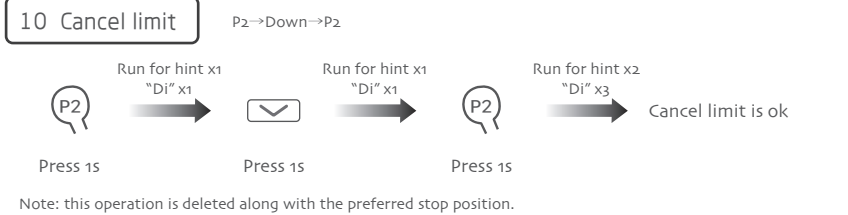

11 Jog & Tilt

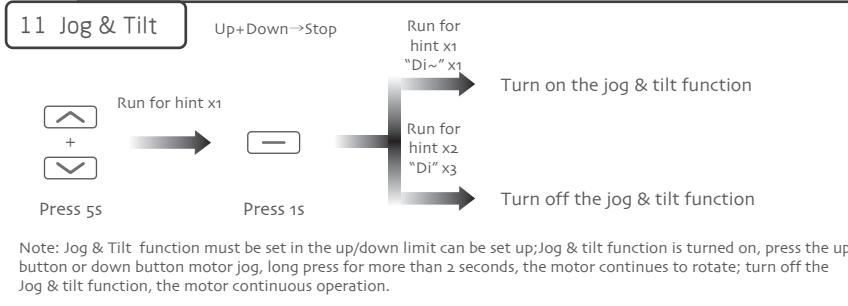

12 Sensitive stall detection

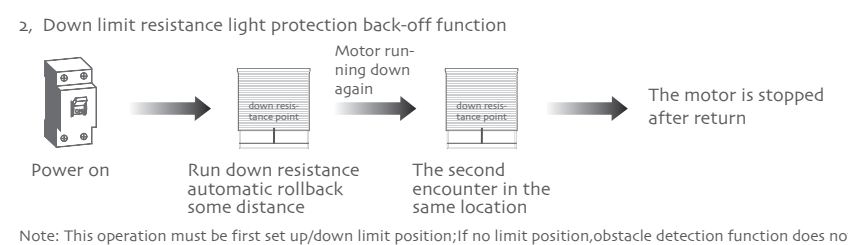
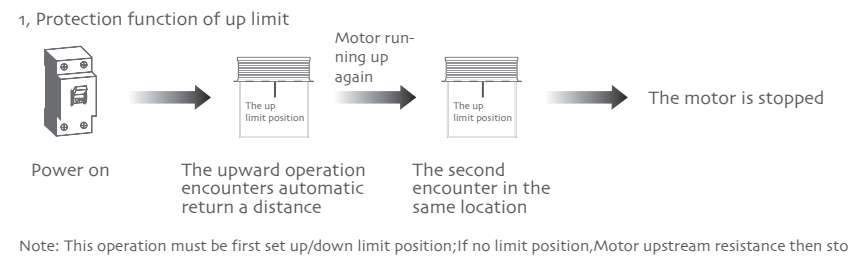

13 Resistance and reboundable switch

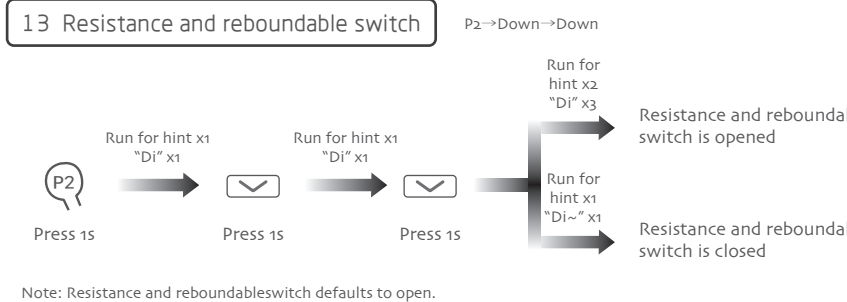

Motor P1 button operation

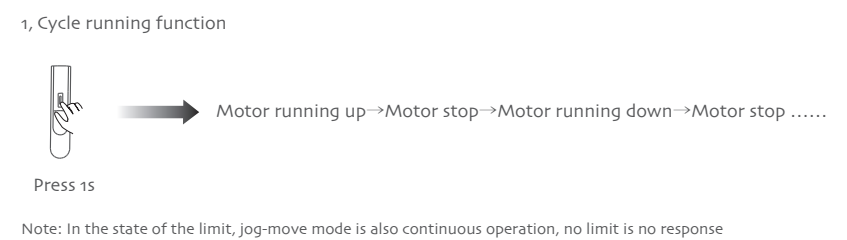

2, Setting up or add emitter

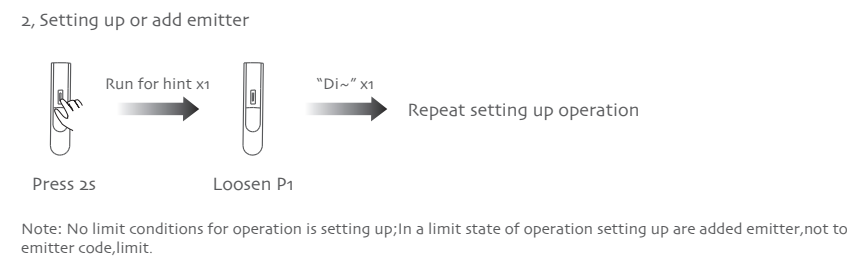

3, Wireless shielding function

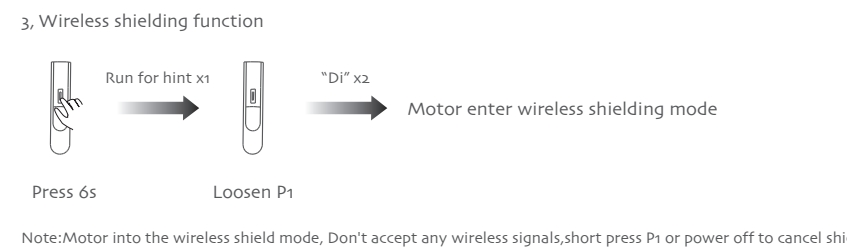

4, Switch Direction

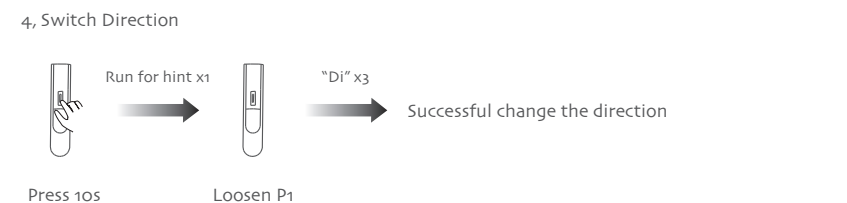

5, Reset to factor mode

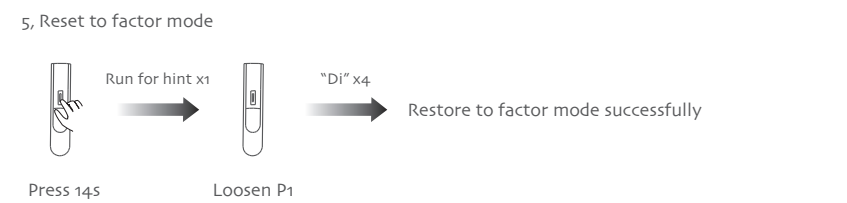

Fault and solution

NUMBER	PHENOMENON	REASON	PROCESSING METHOD
1	Motor can't running	a, The emitter is not matched. b, If long press the P1 button, the motor still don't run, power short-circuit, circuit board bad or motor bad.	a, Setting up again b, Contact after-sales service

Tubular Motor-DM45EAF/S Specification



(A-00)