

SLIM IO RECEIVER SCREEN+PLUG

FR Notice
DE Anleitung
EN Instructions
IT Manuale
ES Manual
PT Instruções
EL Εγχειρίδιο
NL Handleiding
FI Käyttöohje

DA Brugsvejledning
NO Bruksanvisning
SV Bruksanvisning
TR Kılavuz
PL Instrukcja
CS Návod
HU Útmutató
RO Manual
SK Návod na použitie



ORIGINAL INSTRUCTIONS

These instructions apply to all versions of the Slim io Receiver Screen + Plug, which are available in the current catalogue.

CONTENTS

1. Introduction	22	5. Operation and maintenance	26
1.1. Scope of application	22	5.1. Up and Down buttons	26
1.2. Liability	22	5.2. STOP function	26
2. Installation	23	5.3. Favourite position (my)	26
2.1. Installation recommendations	23	5.4. Adding/deleting Somfy io control points and io sensors	27
2.2. Fitting the Slim io Receiver Screen + Plug	23	5.5. Replacing a lost or broken io-homecontrol® Somfy control point	27
3. Wiring	23	6. Tips and recommendations	27
4. Commissioning	24	6.1. Questions on the Slim io Receiver Screen + Plug	27
4.1. Identifying setting steps already completed	24	6.2. Restoring the original configuration	28
4.2. Pre-programming the Somfy io local control point	25	7. Technical data	29
4.3. Checking the motor's direction of rotation	25		
4.4. Setting the time of functioning	25		
4.5. Programming the first Somfy io local control point	26		

GENERAL

Safety instructions

Danger

Indicates a danger which may result in immediate death or serious injury.

Warning

Indicates a danger which may result in death or serious injury.

Precaution

Indicates a danger which may result in minor or moderate injury.

Attention

Indicates a danger which may result in damage to or destruction of the product.

Non contractual images.

1. INTRODUCTION

1.1. SCOPE OF APPLICATION

The Slim io Receiver Screen + Plug is a receiver equipped with io homecontrol® Radio Technology. It is used to control all types of external vertical blinds with standard motors supplied with 230 V (please contact your dealer for further information). The Slim io Receiver Screen + Plug is used to open and close external vertical blinds.

Its small size enables it to be discretely installed near the product it is controlling through a direct supply cable connection.

The Slim io Receiver Screen + Plug can be used as:

- individual control - one Slim io Receiver Screen + Plug is controlled by one control point,
- multiple control - one Slim io Receiver Screen + Plug is controlled by several control points,
- group control - several Slim io Receiver Screen + Plug are controlled by a single control point.

The Slim io Receiver Screen + Plug can be controlled either by one control point or by an automatic control device.

1.2. LIABILITY

Before installing and using the receiver, please read these instructions carefully. In addition to the instructions provided in this guide, please also comply with the instructions set out in the enclosed **Safety instructions** document.

The receiver must be installed by a home motorisation and automation professional, in accordance with Somfy's instructions and the applicable regulations in the country of installation.

Any operation of the receiver outside the scope of application described above is prohibited. Such operation shall exclude Somfy from all liability and invalidate the Somfy warranty, as will any failure to comply with the instructions given herein and in the enclosed **Safety instructions** document.

After installing the receiver, the installer must inform his customers of the operating and maintenance conditions for the receiver and must pass the operating and maintenance instructions on to them, as well as the enclosed Safety instructions document. Any After-Sales Service operation on the receiver requires intervention by a home motorisation and automation professional.

Should any doubt arise during installation of the receiver or for additional information, consult a Somfy contact or visit www.somfy.com.

2. INSTALLATION

2.1. INSTALLATION RECOMMENDATIONS

- Minimum distance (**X**) between a Slim io Receiver Screen + Plug and the ground:
X = 150 cm
- Minimum distance (**Y**) between a Slim io Receiver Screen + Plug and a radio control point:
Y = 30 cm
- Minimum distance (**Z**) between two Slim io Receiver Screen + Plug units:
Z = 20 cm

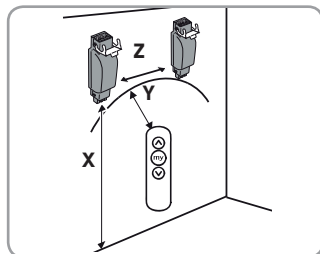

2.2. FITTING THE SLIM IO RECEIVER SCREEN + PLUG



Warning

Comply with current standards and legislation when installing.



Attention

The Slim io Receiver Screen + Plug must be installed, protected from rain and in clement weather conditions, out of sight and out of the reach of children.

- 1) Turn off the power supply.
- 2) Disconnect the motor cable quick connection (**A**) from the power supply cable quick connection (**B**).
- 3) Connect the Slim io Receiver Screen + Plug between the motor cable (**A**) and the power supply cable (**B**).
 - Motor = motor side (**A**)
 - Supply 230 V = power supply side (**B**)
- 4) Lock the securing hooks (**C**).

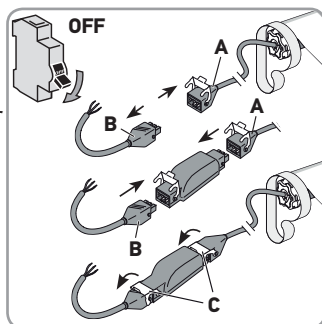

Attention

Ensure that the two quick connections are engaged correctly.

- 5) Place the Slim io Receiver Screen + Plug in the awning bracket to conceal it.
- 6) Fit the Slim io Receiver Screen + Plug (using rilsan cables for example).

3. WIRING

Attention

- Cables routed through a metal internal wall must be protected and insulated by sleeving or sheathing.
- Secure the cables to prevent any contact with moving parts.
- If the receiver is used outdoors and if the power supply cable is of the H05-VVF type, run the cable in a UV-resistant duct, e.g. trunking.
- Leave the receiver power supply cable accessible: it must be easily replaceable.



Warning

Always make a loop in the power supply cable to prevent water from entering the receiver.

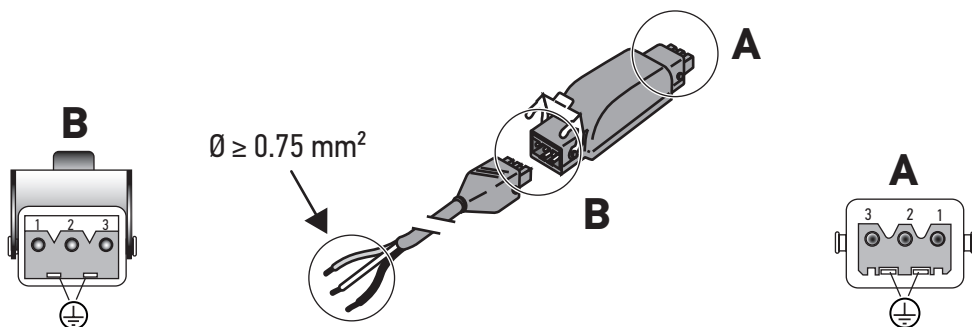

1	Blue	Neutral
2	Black	Live
3	-	-
	Green/yellow	Earth

1	Blue	Neutral
2	Black	Up
3	Brown	Down
	Green/yellow	Earth

- ① To ensure that the radio signal is transmitted correctly, it is necessary to pull the Slim io Receiver Screen + Plug supply cable out of the motorised product by at least 30 cm.

4. COMMISSIONING

This guide only describes commissioning using a Somfy io local control.

For commissioning using any other io control point, refer to the corresponding guide.

- ① *Prerequisite: The end limits of the motor are already set.*

4.1. IDENTIFYING SETTING STEPS ALREADY COMPLETED

Only one motor should be powered at a time.

Switch on and follow procedure **4.1.1** or **4.1.2**, depending on the reaction of the motorised product.

4.1.1. The motorised product moves briefly

The linear travel is set and no Somfy control points have been programmed.

Go to § **4.5**.

4.1.2. The motorised product does not move

Press the **Up** or **Down** button and follow procedure **4.1.2.1** or **4.1.2.2**, depending on the reaction of the motorised product.

4.1.2.1. The motorised product still does not move

The linear travel is not set and the Somfy control point has not been programmed.

Go to § **4.2**.

4.1.2.2. The motorised product raises or lowers completely by pressing and holding the Up or Down button

The linear travel is set and the Somfy control point has been programmed.

Go to § **5**.

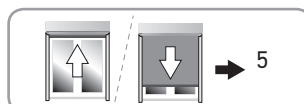
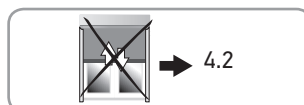
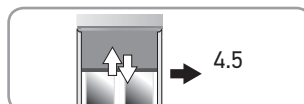
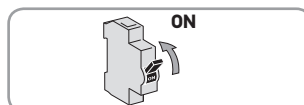

4.2. PRE-PROGRAMMING THE SOMFY IO LOCAL CONTROL POINT

- Press the **Up** and **Down** buttons simultaneously.
The motorised product moves briefly.
The Somfy local io control point is pre-programmed to the motor.

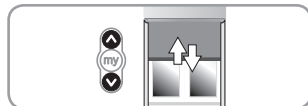

4.3. CHECKING THE MOTOR'S DIRECTION OF ROTATION

- Press the **Up** button on the control point:
 - If the motorised product raises, the direction of rotation is correct.
 - If the motorised product lowers, the direction of rotation is incorrect:
 - Press the **"my"** button on the control point until the motorised product moves. The direction of rotation is modified.
- Press the **Up** button on the control point to check the direction of rotation.

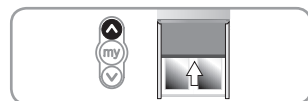
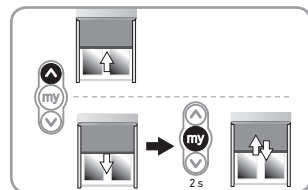

4.4. SETTING THE TIME OF FUNCTIONING

4.4.1. Automatic mode

- ① *This mode is not advised when the receiver is used with Nina, Tahoma, or Connexoon.*

- Check the rotation direction of the motor (see § 4.3).
- Press the **Up** and **Down** buttons simultaneously for at least 5 seconds.
- Press the **"my"** button for at least 2 seconds.
The motorised product moves briefly and
Time of functioning T(f) = 4 min.
- Go to § 4.5.

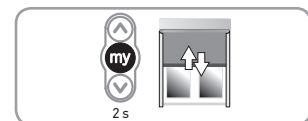
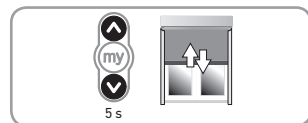

4.4.2. Manual mode

The time of functioning is measured during the setting.

- ① *This mode is used in order to have better precision when the receiver is used with Nina, Tahoma, or Connexoon.*



Attention

The motor must be previously set.

- Check the rotation direction of the motor (see § 4.3).
- Press the **Up** and **Down** buttons simultaneously for at least 5 seconds.
The motorised product moves briefly and the manual mode is activated.
- Press and hold the **Up** button and let the motorised product reach its up end limit.
- Briefly press the **Up** and **Down** buttons simultaneously.
The motor goes downward and calculates its Time of functioning T(f).

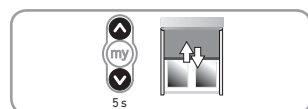

- 5) When the motor arrives at its down end limit, press the **"my"** button for at least 2 seconds.

The motorised product moves briefly.

Time of functioning = T(f) (Max = 4 min).

- 6) Go to § 4.5.

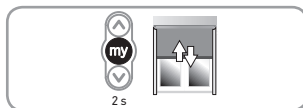

4.5. PROGRAMMING THE FIRST SOMFY IO LOCAL CONTROL POINT

4.5.1. Using a pre-programmed Somfy io local control point

- Briefly press the **PROG** button on this control point.
The motorised product moves briefly.
The control point is programmed.

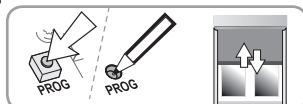

4.5.2. After a power cut

- Press the **Up** and **Down** buttons simultaneously on the new control point until the motorised product moves.
- Briefly press the **PROG** button on this control point.
The motorised product moves briefly.
The control point is programmed.

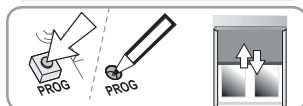
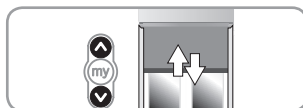

5. OPERATION AND MAINTENANCE

5.1. UP AND DOWN BUTTONS

Briefly press the **Up** or **Down** button to raise or lower the motorised product fully.

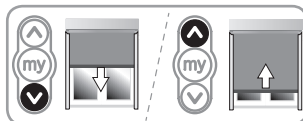

5.2. STOP FUNCTION

The motorised product is moving.

- Briefly press the **"my"** button on the control point.
The motorised product stops automatically.

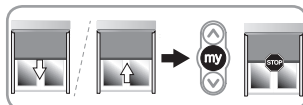

5.3. FAVOURITE POSITION (MY)

Besides the upper and lower positions, an intermediate position known as the "favourite position (my)" may be programmed in the receiver.

5.3.1. Setting the favourite position (my)

- Place the motorised product in the requested favourite position (my).
- Press the **"my"** button on the control button until the motorised product moves.
The favourite position (my) has been programmed.



5.3.2. Using the favourite position (my)

- Briefly press the **"my"** button.
The motorised product starts to move, then stops. The position of the motorised product then complies with the favourite (my) position programmed.

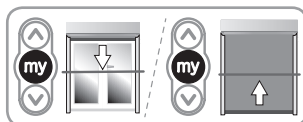

5.3.3. Modifying the favourite position (my)

- 1) Place the motorised product in the required new favourite position (my).
- 2) Press the **"my"** button on the control button until the motorised product moves.

The new favourite position (my) has been programmed.

5.3.4. Deleting the favourite position (my)

- 1) Briefly press the **"my"** button.

The motorised product will start to move and stop in the favourite position (my).

- 2) Press the **"my"** button on the control button until the motorised product moves.

The favourite position (my) has been deleted.

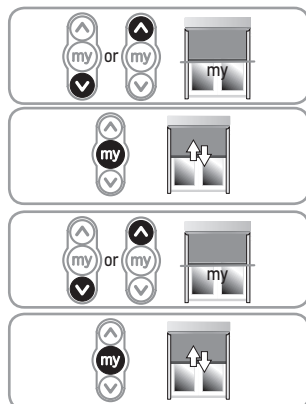

5.4. ADDING/DELETING SOMFY IO CONTROL POINTS AND IO SENSORS

Refer to the corresponding guide.

5.5. REPLACING A LOST OR BROKEN IO-HOMECONTROL® SOMFY CONTROL POINT

To replace a lost or broken io-homecontrol® control point, consult a home motorisation and automation professional.

6. TIPS AND RECOMMENDATIONS

6.1. QUESTIONS ON THE SLIM IO RECEIVER SCREEN + PLUG

Observations	Possible causes	Solutions
The motorised product does not operate.	The wiring is incorrect.	Check the wiring of the the Slim io Receiver Screen + Plug and modify it if necessary.
	The motor is in heat protection mode.	Wait until the motor cools down.
	The Somfy io control point battery is low.	Check whether the battery is weak and replace it if necessary.
	The control point is not compatible.	Check for compatibility and replace the control point if necessary.
	The Somfy io control point used has not been programmed into the receiver.	Use a programmed control point or program this control point.
The motorised product stops too soon or too late.	The end limits have been incorrectly set.	Readjust the end limits.
The "my" position is not working.	The "my" position is deleted.	Program the "my" position.
I can't delete the "my" position with my Easy Sun io control point.	Your control point is too old (Index E or older).	Delete the "my" position with another paired control point.

Observations	Possible causes	Solutions
I have a wind sensor and the motorised product rises to the upper end limit every hour.	The sensor is paired/set.	There is radio interference or the sensor is out of reach. Position the the Slim io Receiver Screen + Plug outside the head rail.
	The battery of the Somfy io wind sensor is weak.	Check whether the battery is weak and replace it if necessary.
Despite the presence of a wind sensor, when it is windy, the motorised product does not reach the upper position.	The sensor is not paired/set.	Refer to the corresponding guide to pair/set the sensor.
I don't think the position between the end limits is accurate.	The linear travel setting is incorrect.	Reset the linear travel.
	The motor is close to the thermal limit.	Wait until the motor cools down.

6.2. RESTORING THE ORIGINAL CONFIGURATION

Attention



Only switch off power (double cutout) for the motorised product to be reset.

This reset deletes all programmed control points, sensors, linear travel and resets the motorised product's favourite (my) position.

- 1) Position the motorised product at its half-way position.



- 2) Cut the power supply for 2 seconds.

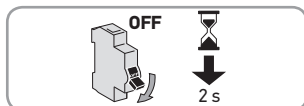

- 3) Switch the power supply back on for 5 to 15 seconds.

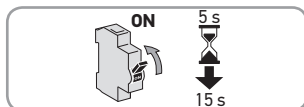

- 4) Cut the power supply for 2 seconds.

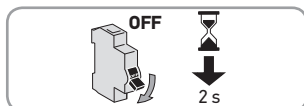

- 5) Switch the power supply back on.
The motorised product moves for a few seconds.

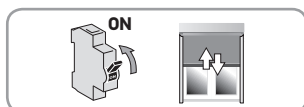

- 6) Press the **PROG** button on the Somfy io-homecontrol® local control point for ≈ 7 s until the motorised product moves up and down twice.

The receiver is reset to its original configuration.

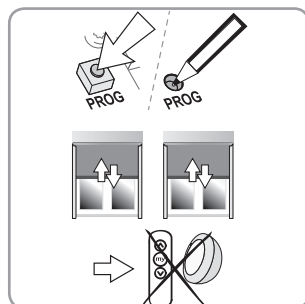

7. TECHNICAL DATA

Power supply	220 - 240 V / 50 Hz
Index protection rating	IP 54
Electrical insulation	Class I
Maximum number of associated control points and sensors	9
Radio frequency	868-870 MHz io-homecontrol®, two-way Tri-band
Frequency bands and maximum power used	868.000 MHz - 868.600 MHz ERP < 25 mW 868.700 MHz - 869.200 MHz ERP < 25 mW 869.700 MHz - 870.000 MHz ERP < 25 mW
Operating temperature	- 30 °C à + 70 °C
Number of operating cycles	10000
Pollution index	2
Maximum power	690W
Rated current	3A
Rated impulse withstand voltage	2500V
Duty type	S3
Switch type	

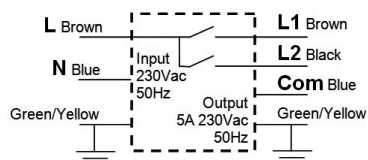

PTI (Proof Tracking Index)	> 175V
Cooling condition	No forced cooling
Protection device	No protection device
Break type	Microbreak
Load type	$\cos \phi > 0,9$
Design	Independently mounted switch
Glow wire temperatures	850°C
Coating type for PCB	Type A
CTest conditions	Simulated with a practically resistive load



Somfy hereby declares that the radio equipment covered by these instructions is in compliance with the essential requirements of Radio Directive 2014/53/EU and the other essential requirements of the applicable European Directives.

The full text of the EU declaration of conformity is available at www.somfy.com/ce.